

↑ NORDEN

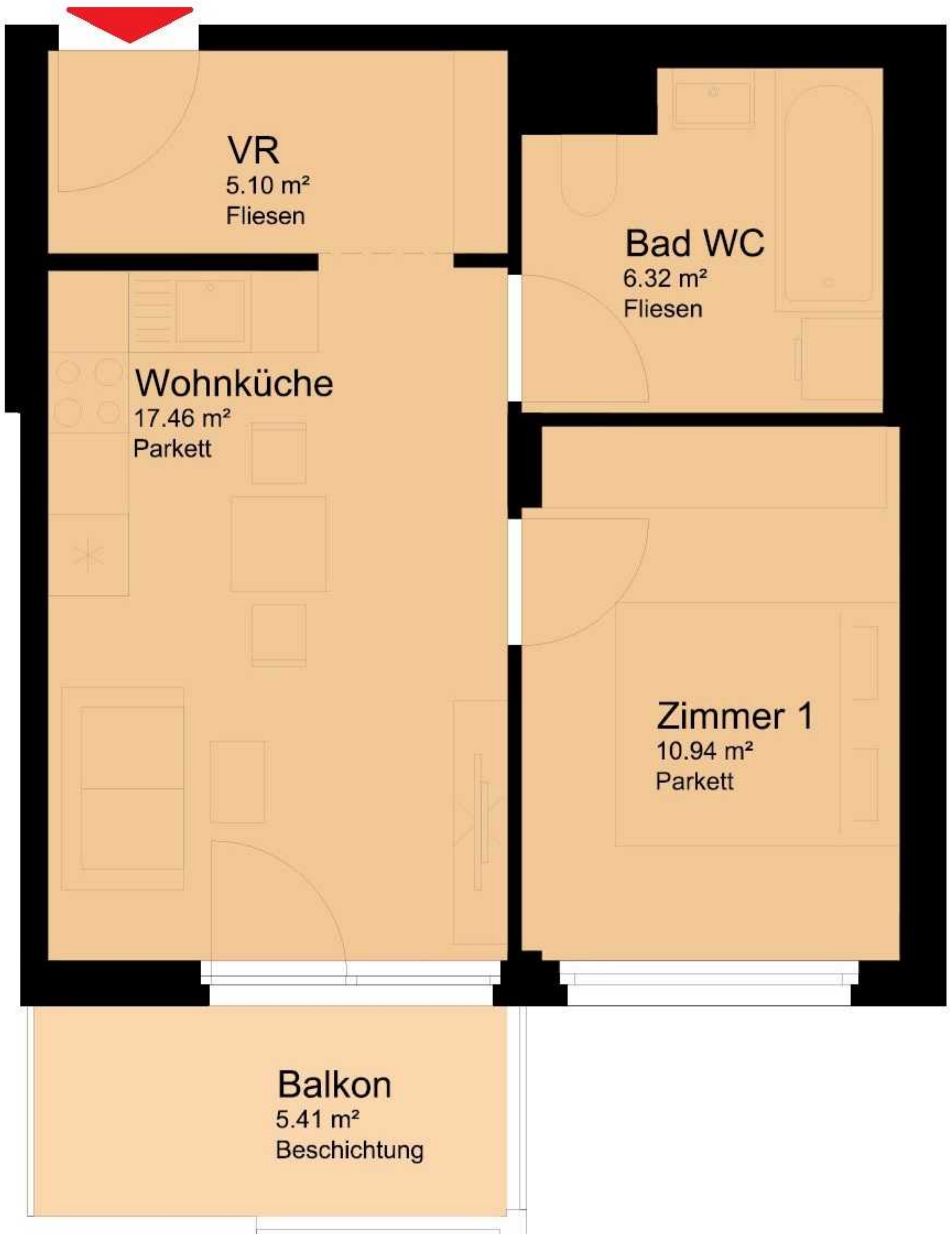

**VR**  
5.10 m<sup>2</sup>  
Fliesen

**Bad WC**  
6.32 m<sup>2</sup>  
Fliesen

**Wohnküche**  
17.46 m<sup>2</sup>  
Parkett

**Zimmer 1**  
10.94 m<sup>2</sup>  
Parkett

**Balkon**  
5.41 m<sup>2</sup>  
Beschichtung